

97-LD Series Flush Bolt

- Steel construction/zinc finish
- Beveled bolt design
- Available with standard or reverse bolt
- Available with/without mounting holes
- Available with optional finger pull designs
- Available with optional spring tensions 4#, 9#, 14#



S97LDXXXZNNH



S97LDXXXZNWH

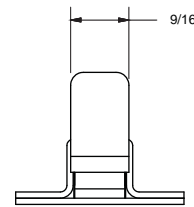
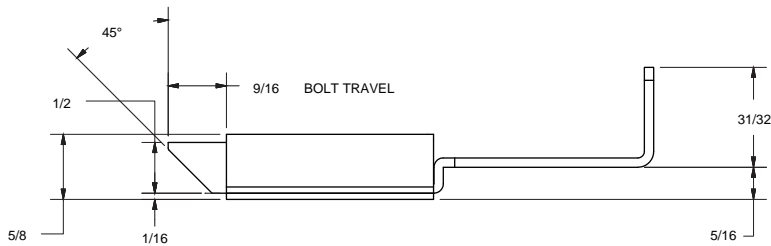
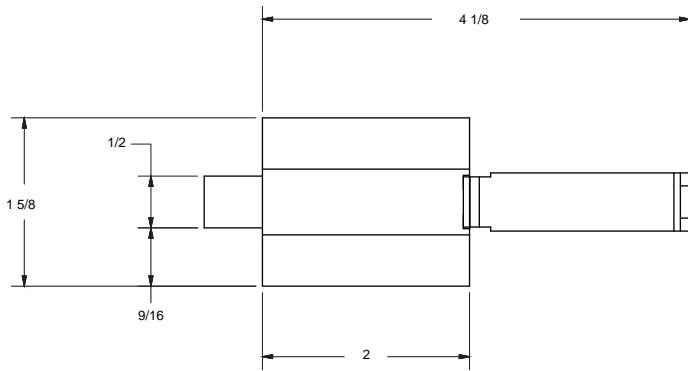

Bolt Directions

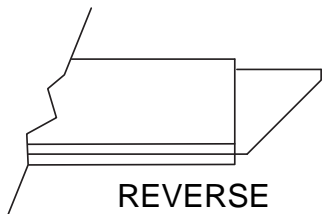
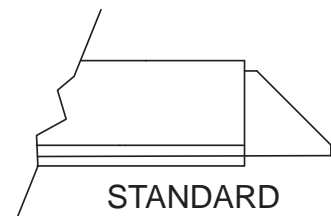

Optional Finger Pull Designs

